

Safe data reading from CAN bus

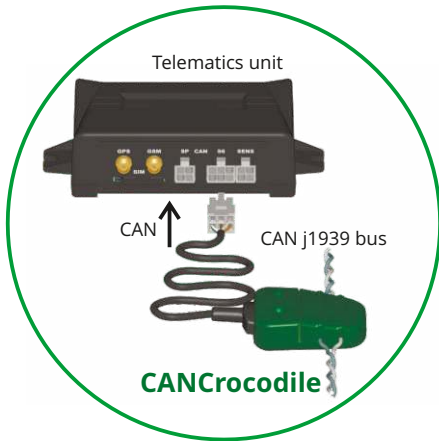

CANCrocodile is used in vehicle telematics system for reading signals from T-CAN and M-CAN data buses without wire insulation damage.

- ✓ Protecting vehicle electronic systems against active requests from telematics unit.
- ✓ Saving warranty for a vehicle.
- ✓ Quick and easy installation without configuration.

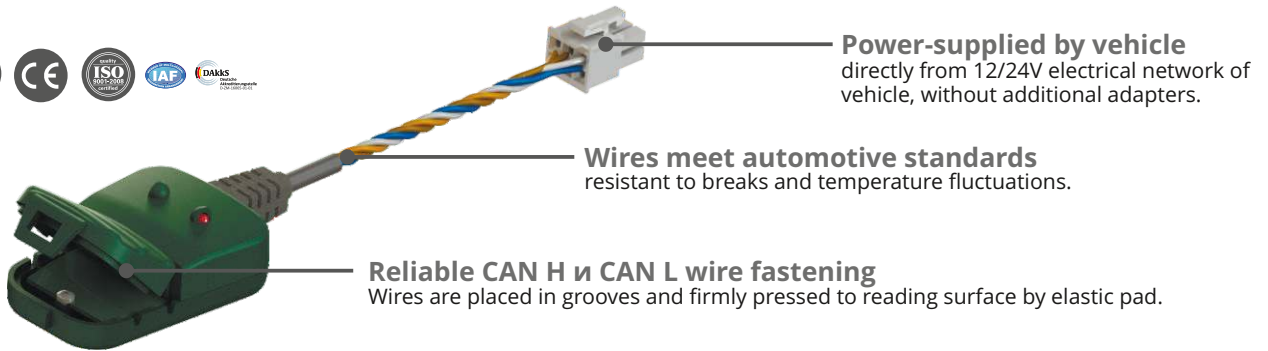

Power-supplied by vehicle
directly from 12/24V electrical network of vehicle, without additional adapters.

Wires meet automotive standards
resistant to breaks and temperature fluctuations.

Reliable CAN H и CAN L wire fastening
Wires are placed in grooves and firmly pressed to reading surface by elastic pad.

Easy installation - no special tools needed

- 1 Open CANCrocodile case.
- 2 Put CAN H and CAN L wires along the marks on reading surface.
- 3 Close the case until click and connect CANCrocodile wires to telematics unit's CAN-port and electrical network of vehicle.

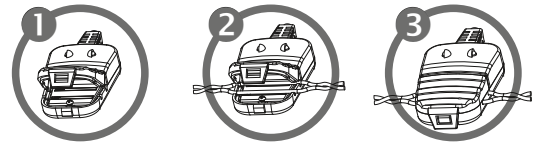

Modifications

Main. LED indication of operating modes:
● - power on, ● - data transfer in progress.

A++. No LED indicators.
Low standby current: 1/0.5 mA for 12/24 V voltage.

Mini. LED indication of operating modes. Reduced overall dimensions.

Specifications

Power supply voltage, U12/24 version	10...50 V
Power supply voltage, U5 version	4,5...5,5 V
Compatibility	SAE J1939, CAN Open, DeviceNet, NMEA 2000
Output cable length, basic version	0,7 m
Operating temperature	-40...+85 °C
Output cable ending	connector / bare wires

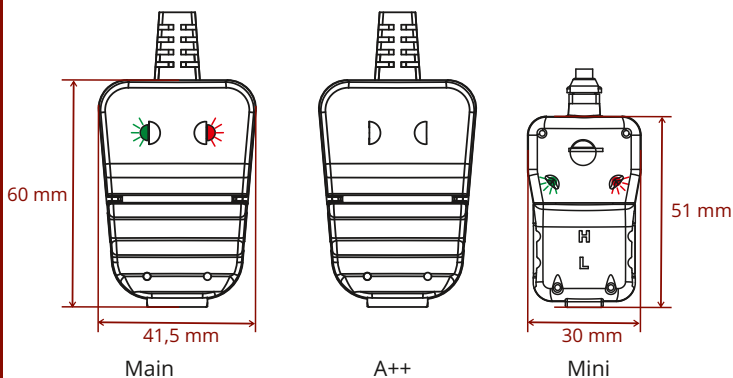

phone +420 910 122 429
WhatsApp +420 704 067 474
e-mail: sales@jv-technoton.com
www.jv-technoton.com

